

DRYmix™

●●●● DRY DIGESTION AGITATOR

- Suitable for various types of large-scale horizontal solid waste treatment tanks.
- Uniformly mixed, low energy consumption.
- Easy to install and maintain.



Suitable for fermenters from 1000m³ to 3000m³

AGRICULTURE
HUSBANDRY
KITCHEN WASTE

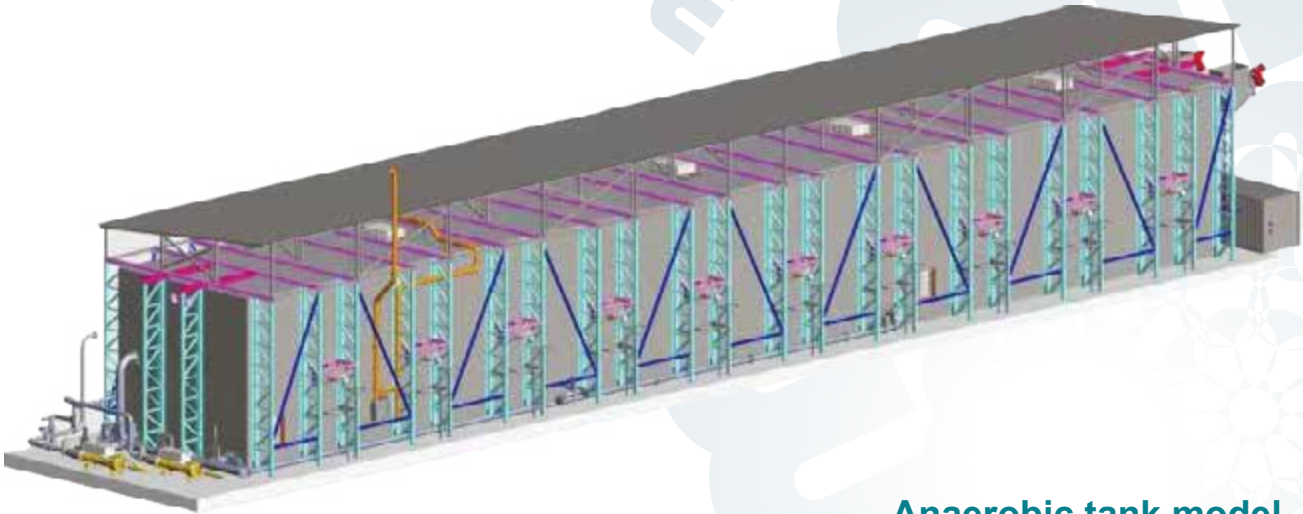

Anaerobic tank model

► Operating conditions

- Anaerobic media with 20%-50% solid content, operating at 55°C reaction temperature, 50 mbar working pressure, and 20-day material residence time.

► Design

- The design power of a single unit can reach up to 75kW, subject to specific design considerations.
- Shaft length (excluding shaft ends) >8000mm.
- Rotational speed: 1r/min (+/-10%)
Rotation direction: Clockwise/Counterclockwise
- Materials: stainless steel, carbon steel, coated steel, alloy materials, etc.
- Each anaerobic tank is equipped with multiple paddle, anchored to concrete structures or steel structures.

► Convenient installation and maintenance

- The special impeller retaining mechanism design ensures easy installation.
- The design of the special sealing system ensures the reliability of equipment in hazardous environments.



Type	Power [kW]	Rotational Speed [rpm]	Φ Propeller [mm]	Shaft length [mm]	Torque [KN.m]	Weight [kg]
DRYMIX 3000	5.5	1	3000	6000	46.7	3600
DRYMIX 4000	7.5	1	4000	6000	63.4	5000
DRYMIX 6000	11	1	6000	7000	97	8000
DRYMIX 8000	15	1	8000	9000	124	11000

MIXEL can design customized specifications according to user requirements.